

oil seal R01-F

seal spec

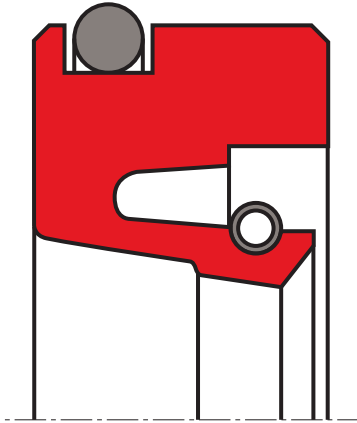

description

spring loaded PTFE-lip seal for axially open housings with clamping plate fixation, elastic secundar seal or integrated O-Ring necessary for static sealing in the housing excellent chemical and thermal resistance, allowable pressure and speed depend on each other, it is not recommended to use all maximum values simultaneously.

application



category of profile

machined or molded/standard/trade product

single acting

operating parameters & material

diameter range: up to 600 mm

material		temperature	max. surface speed	max. pressure ¹
glide ring	O-ring			
s-mart PTFE glass	NBR 70 shore A	-30 °C ... +100 °C	10 m/s	15 bar (210 psi)
s-mart PTFE glass	FKM 75 shore A	-20 °C ... +200 °C	10 m/s	15 bar (210 psi)
s-mart PTFE bronze	NBR 70 shore A	-30 °C ... +100 °C	10 m/s	15 bar (210 psi)
s-mart PTFE bronze	FKM 75 shore A	-20 °C ... +200 °C	10 m/s	15 bar (210 psi)
s-mart PTFE carbon	NBR 70 shore A	-30 °C ... +100 °C	10 m/s	15 bar (210 psi)
s-mart PTFE carbon	FKM 75 shore A	-20 °C ... +200 °C	10 m/s	15 bar (210 psi)

the stated operation conditions represent general indications. it is recommended not to use all maximum values simultaneously. surface speed limits apply only to the presence of adequate lubrication film.

¹ pressure ratings are dependent on the size of the extrusion gap.

surface quality

surface roughness	Rtmax [µm]	Ra [µm]
shaft	≤6,3	≤0,2-0,8
bottom of groove	≤25	≤1,6-6,3

tolerance recommendation

seal housing tolerances	
Ød	f8
ØD	H8
ØD1	H11



seal & housing recommendations

please note that we are able to produce those profiles to your specific need or any non standard housing. for detail measurements, please see seal-mart catalog...

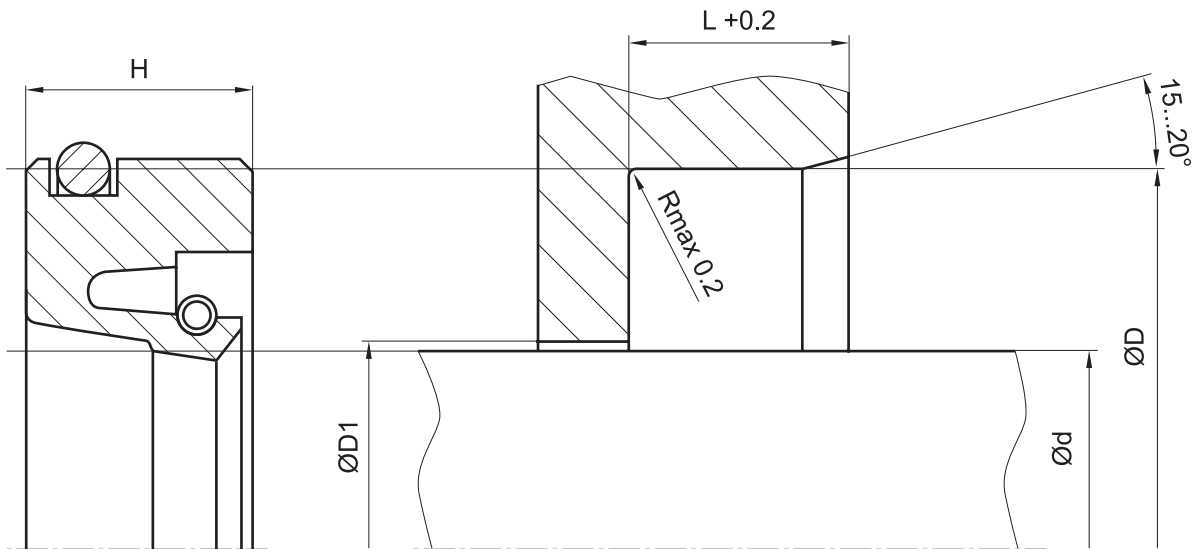

don't hesitate to contact our technical department for further information or for special requirements (temperature, speed etc.), so that suitable materials and/or designs can be recommended.